

VALVE AUTOMATION & FITTINGS



VALVE AUTOMATION & FITTINGS

Spraytech Automation India Pvt Ltd is a manufacturer, supplier and exporter of premium quality of Industrial Control Valves and Fittings. Spraytech is an esteemed name in Control Valves for isolation, control and flow reversal applications. Spraytech make globe control valves are hugely utilized in critical industrial applications like steam, utility, and process pipelines.

Today we are considered to be a leading supplier and exporter of a wide range TC end butterfly valves, Stainless steel butterfly valves, IRIS diaphragm valve, Ball valve / flush bottom valve, TC end ball valves, Ball valve / flush bottom valve, Non return valves, TC ferrule, TC clamps.

We attribute our success to our motivated and skilled work force who can accomplish job orders of varying magnitudes and complexities. We are proud to have esteemed customers who have entrusted their faith in us over the years.

The aim of our organization is customer satisfaction which is achieved through following objectives : Innovation, Commitment to quality, Technological solutions, On time delivery, After sales service. Our challenge is to meet the widely ranging delivery demands of an equally diverse customer base coupled with constant up gradation of production equipment and techniques to keep pace with new market trends and applications.

- TC END BUTTERFLY VALVES
- STAINLESS STEEL BUTTERFLY VALVES
- IRIS DIAPHRAGM VALVE
- BALL VALVE / FLUSH BOTTOM VALVE
- TC END BALL VALVES
- BALL VALVE / FLUSH BOTTOM VALVE
- NON RETURN VALVES
- TC FERRULE
- TC CLAMPS



Chemical



Fertilizer



Power



Oil & Gas



Water Treatment



Pharma



Paper & Pulp



Steel



Cement

Innovation

Innovation is the introduction of new ideas, methods, or things. We must promote originality and encourage innovation.

Quality

Improving products, services, systems and processes, to making sure that the whole organisation is fit and effective.

Prompt Services

We are pleased to introducing ourselves as a professionally managed after sales, service provider company.

TC END BUTTERFLY VALVES



Sanitary Butterfly Valves are designed and manufactured to perform reliably in the most hostile production environments. Each valve is meticulously constructed using the finest materials. Valves come standard with a 4 position handle design for multiple flow options and feature specially designed integrated actuator mounting holes to precision align optional actuators. Valves are precisely CNC machined from 304/316 stainless steel and feature an I.D. finish of less than 0.6mm R.A. Body bolts are cross threaded to help ensure a tight seal.

FEATURES

Material and Gasket : 304/316 Stainless steel, silicon seats (Other Available)

Available Size : 0.50", 0.75", 1.0", 1.5", 2.0", 2.5", 3.0" 4.0", 6.0" and 8"

Surface Finish : less than 0.6mm (RA) mechanical sanitary polish sanitary clamp, butt weld and SMS.

Connections : Sanitary clamp, butt weld and SMS

Actuation : Integrated mounting slot accept a variety of actuators

Maximum Pressure : 1.0" - 4.0" to 5 bar at 68°F (20°C)

Temperature / Vacuum : Vacuum to 1 bar at 68°F (20°C), temperature rating 15°F to 200°F (10°C to 95°C)

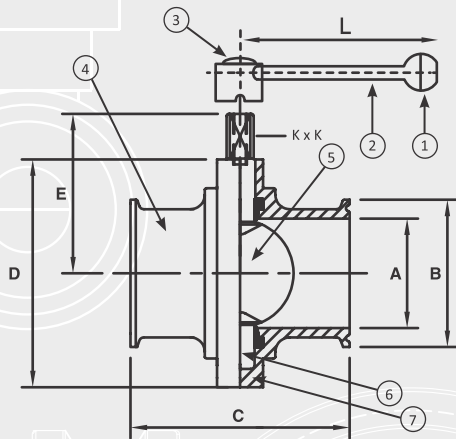

Dimensions

Size	A	B	C	D	E	L	Torque (Kg-M)
1"	22.1	50.5	60.0	75.0	60.0	110	1
1 1/2"	34.8	50.5	60.0	77.0	60.0	110	1
2"	47.5	64.0	60.0	90.0	60.0	110	1.3
2 1/2"	60.2	77.5	60.0	110.0	60.0	110	1.5
3"	72.2	91.0	74.0	128.0	60.0	110	2.0
4"	97.6	119.0	90.0	154.0	60.0	110	3.1
6"	148.4	167.0	85.0	200.0	60.0	185	5.5
8"	199.2	217.0	88.0	250.0	60.0	250	6.1
10"	250	268	90.0	300.0	204.0	250	8.5
12"	300	319	90.0	350.0	229.0	250	10.6

No.	Description	Qty.	Material
1	Upper Handle	1	Reinforced Nylon
2	Lower Handle	1	Stainless Steel
3	Notchplate	1	Stainless Steel
4	Body	1	316L Stainless Steel
5	Disk	1	316L Stainless Steel
6	Silicon Seat	1	Silicon
7	Screw Bolt	1	Stainless Steel

STAINLESS STEEL BUTTERFLY VALVES WITH PNEUMATIC ACTUATORS



Stainless steel butterfly valves are ideally suited for use powder dispensing systems in the pharmaceutical, food and associated Industries. The valve is designed for easy connection to a range of powder processing equipment.

FEATURES

GMP compliant design Flexible interchangeable system is adaptable to multiple powder handling equipment 316L Stainless Steel contact parts provides Superior corrosion resistance. Reduces risk of contamination. Long service life.

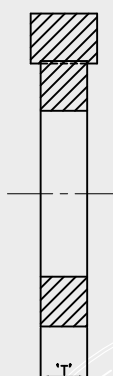
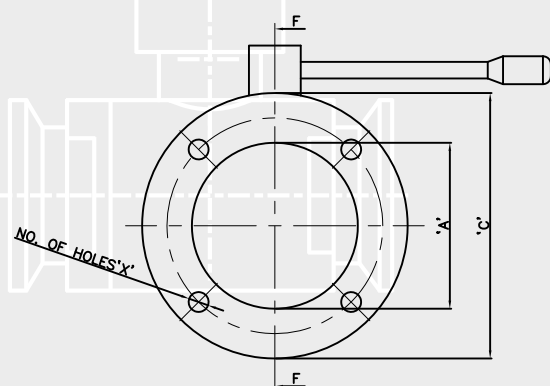

SECTION F-F

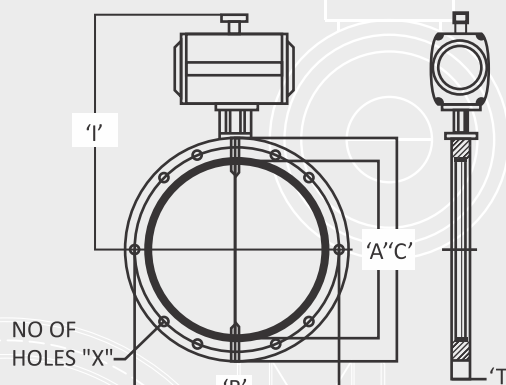

Dimensions

SIZE	ID "A"	PCD "B"	OD "C"	NO. OF HOLES "X"	HOLE DIA.	"T" THICKNESS	"I" Height
1"	25	65	85	4	6.35	25	Depends on Actuator brand
1.5"	38	74	95	4	6.35	25	
2"	50	97	118	4	7.9	26	
2.5"	63	105	127	4	7.9	26	
3"	76	128	144	4	7.9	26	
4"	100	142	160	4	7.9	25	
5"	127	175	200	6	9.5	25	
6"	150	203	225	6	9.5	25	
8"	200	264	285	6	9.5	28	
10"	250	298	335	6	11	28	
12"	300	360	385	8	14.5	30	
13"	330	385	420	8	14.5	32	
14"	350	415	440	8	14.5	35	
16"	400	460	490	10	17.5	35	
18"	457	508	540	10	17.5	35	
20"	508	565	600	12	17.5	35	
22"	558	625	675	12	17.5	40	

IRIS DIAPHRAGM VALVE



Iris Diaphragm Valve is the most popular product and is widely used for in-line application. This flagship product provides the very best features of the Iris Diaphragm Valve, in a robust and cost effective solution.

FEATURES

Double diaphragm for in-line application with no leakage to atmosphere In-site diaphragm adjustment, reducing maintenance time Proven design suitable for frequent operation Diaphragms selected to suit application 316 stainless steel contact parts Multi-notching to enhance flow control.

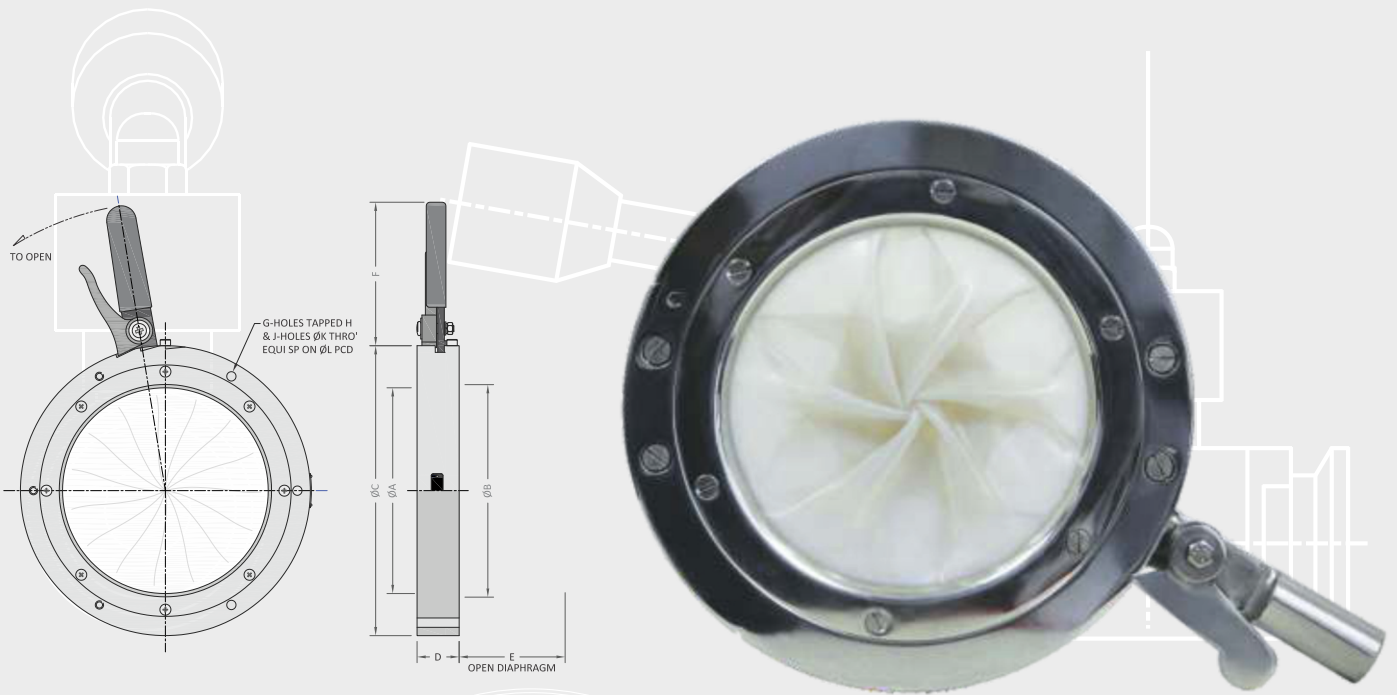

Dimensions

Valve Size	Nominal Bore	A	B	C	D	E	F	G	H	J	K	L
3"	80	73	78	127	35	38	109	3	M6	3	7	113
4"	100	102	106	172	36	50	136	3	M8	3	9	156
6"	150	147	153	228	41	75	136	3	M8	3	9	203
8"	200	198	204	280	41	102	136	3	M8	3	9	254
10"	250	250	260	356	52	127	174	4	M10	4	11	327
12"	300	300	310	406	52	152	174	4	M10	4	11	378
15"	380	381	387	498	59	190	180	6	M10	6	11	470

BALL VALVE / FLUSH BOTTOM VALVE (BAR STROKE)



The Sanitary ball valve Screwed end to minimize pockets where media can collect. The inner diameters and end connections are exactly the same size as the ID of the ball/seat ensuring no obstruction of flow from tubing through the valve.

FEATURES

In sizes from 1/2" through 4" with tube ID design to provide unobstructed flow and better drainage. Pressure ratings up to 900 psi Virgin Teflon cavity filler ISO 5211 actuator mounting flange (optional) Designed for simple maintenance with in-line repairable feature Screwed end or tube weld ends Available as manual or actuated (Pneumatic) valve Stainless Steel Materials - Types 304, 316, And "L Grades"

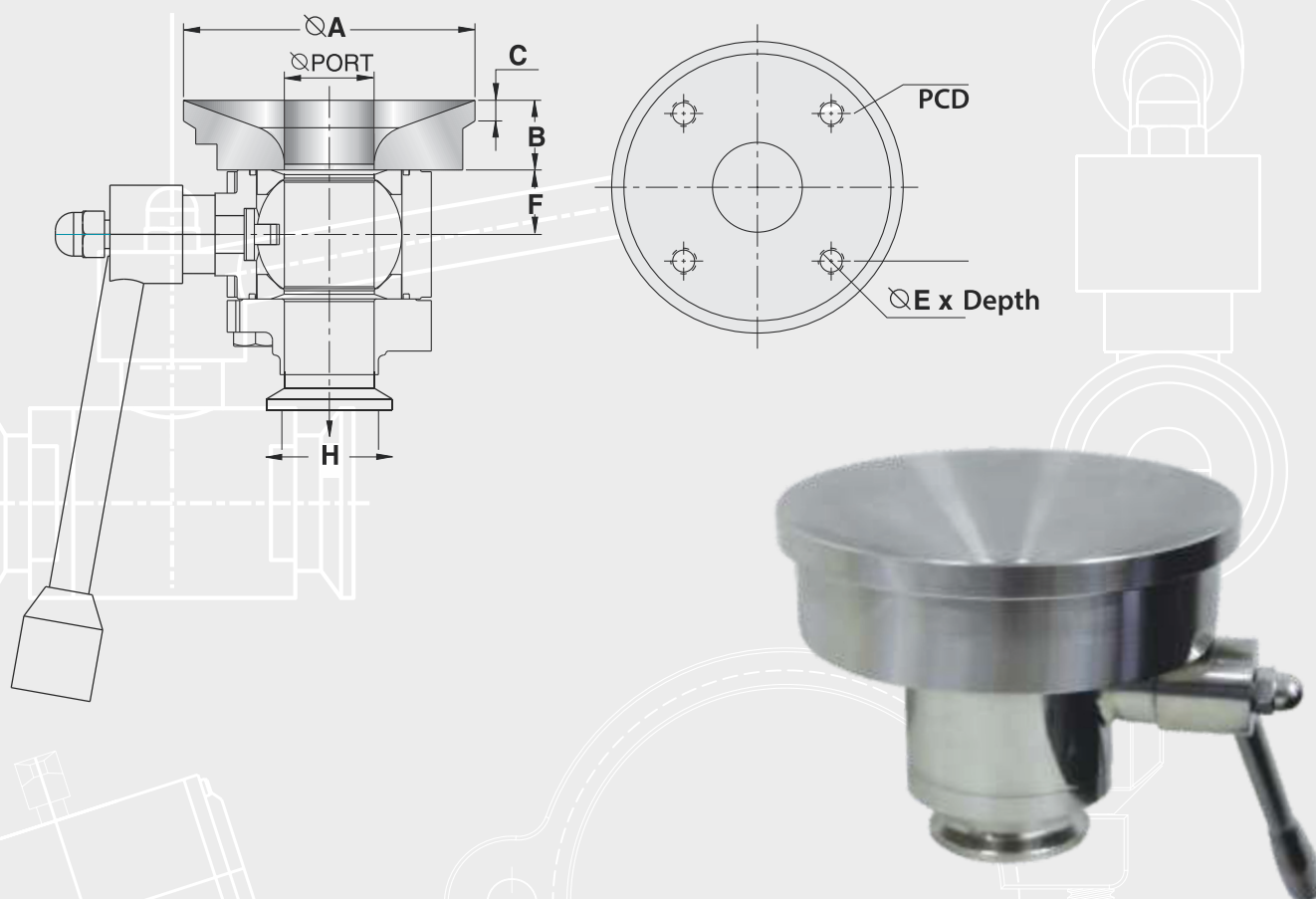

Dimensions

SIZE	Portø	A	B	C	PCD x Hole	F	H	E x Depth
1"	22.1	118	25	8	79.4 x 4	14	50.5	M8 x 9mm
1 1/2"	34.8	135	25	8	98.5 x 4	18	50.5	M8 x 9mm
2"	47.8	152	30	8	120.6 x 4	23	64	M10 x 12mm
2 1/2"	60.2	178	35	10	139.7 x 4	33	77.5	M10 x 12mm
3"	72.9	190	24	10	160 x 4	38	91	M10 x 12mm
4"	97.38	254	45	12	190.5 x 4	55	119	M16 x 18mm

TC END BALL VALVES (BAR STROKE)



The TC End ball valve consists of a stainless steel body that house a rotating ball. The rotating ball is sealed in the body with PTFE seat that either partially or fully encapsulates the ball. The valve is activated by a stainless steel handle that opens and closes the valve through a quarter turn. The valve can also be operated by an optional 1/4 turn pneumatic actuator. maintain constant pressure on the stem packing. The stem and packing design eliminate the possibility of stem becoming dislodged or blown out.

FEATURES

Material and Gasket : 304/316 stainless steel, PTFE seat (other available)

Available Sizes : 0.50", 0.75", 1.0", 1.5", 2.0", 2.5", 3.0" and 4.0"

Surface Finish : Mechanical sanitary polish

Connections : Sanitary Clamp, Buttweld

Pressure : 25 bar pressure

Temperature / Vaccume : Vaccume to 25 bar at 68°F (20°C), temperature rating : 15°F to 200°F (10°C to 95°C)

Application : Water, Steam, Oil, Chemicals

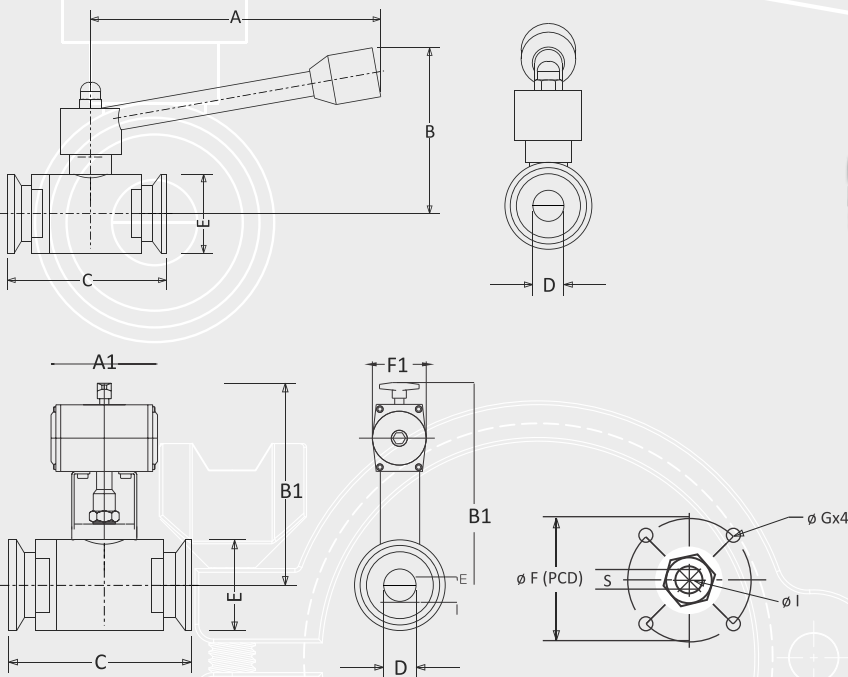
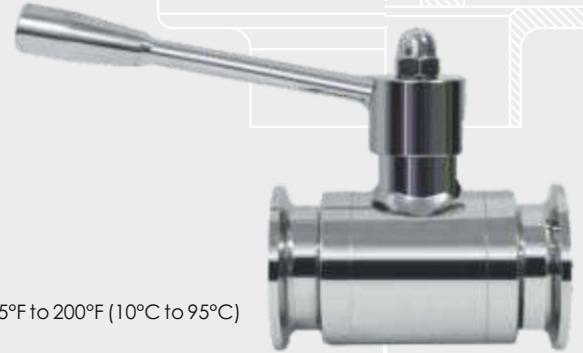

Dimensions

SIZE	A	B	C	Dø	Eø	øF PCD	GX4	øI	S	A1	B1	F1
1/2"	110	71.5	70	9.5	25	36	M6	8	5	141	145	65
3/4"	110	72.5	80	15.9	35	36	M6	10	7	141	150	65
1"	110	76.5	78	24	50.5	36	M6	10	7	169	155	65
1 1/2"	125	88	105	34.5	50.5	50	M6	12	9	169	175	65
2"	185	95	114	47.2	64	50	M6	12	9	197	205	80
2 1/2"	200	125	144	63	77.5	70	M8	20	12	197	250	80
3"	215	150	157	71	91	70	M8	24	16	233	350	122
4"	215	155	180	100	119	70	M8	28	20	272	375	122

BALL VALVE / FLUSH BOTTOM VALVE (BAR STROKE)



The Sanitary ball valve with Screwed end to minimize pockets where media can collect. The inner diameters and end connections are exactly the same size as the ID of the ball/seat ensuring no obstruction of flow from tubing through the valve.

FEATURES

In sizes from 1/2" through 4" with tube ID design to provide unobstructed flow and better drainage. Pressure rating up to 900 psi Virgin Teflon cavity filler ISO 5211 actuator mounting flange (Optional) Designed for simple maintenance with in-line repairable feature Screwed end or tube weld ends Available as manual or actuated (Pneumatic) valve Stainless Steel Materials - Types 304, 316, and "L Grades"

FLUSH BOTTOM VALVE

Description will be provided as per client request

APPLICATIONS IN THE FOLLOWING INDUSTRIES :

Pharmaceutical, Biotech, Healthcare/Cosmetics, Food & Beverage, Specialty Chemical

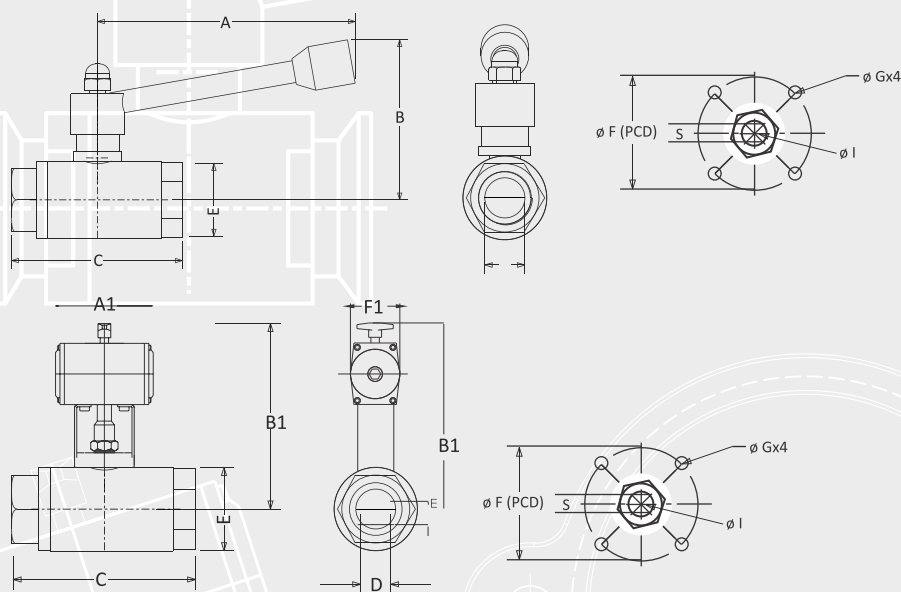

Dimensions

SIZE	A	B	C	Dø (BSP)	øF PCD	GX4	øI	S	A1	B1	F1
1/2"	110	71.5	70	1/2"	36	M6	8	5	141	145	65
3/4"	110	72.5	80	3/4"	36	M6	10	7	141	150	65
1"	110	76.5	76	1"	50	M6	10	7	169	155	65
1 1/2"	125	88	105	1 1/2"	50	M6	12	9	169	175	65
2"	185	95	114	2"	50	M6	12	9	197	205	80
2 1/2"	200	125	144	2 1/2"	70	M8	20	12	197	250	80
3"	215	150	157	3"	70	M8	24	16	233	350	122
4"	215	155	180	4"	70	M8	28	20	272	375	122

NON RETURN VALVES



SS Non Return Valve, which is applicable in various industries for different applications. It is a valve that allows flow of liquid and gas in one direction. Generally, it is used for domestics as well as industrial purpose. We are specialist in developing multi-featured valve that require low maintenance, less energy. They are constructed as per standard industrial principle and by keeping in the mind the diverse need of the client. Its small drops feature makes it different from other which make it suitable for smallest opening pressure. These stainless steel made valves are offered in large choice. These are widely used in the pipeline with liquid and other fluid.

FEATURES

Material and Gasket: 304/316 stainless steel, silicon seats (other available)

Available Sizes: 0.50", 0.75", 1.0", 1.5", 2.0", 2.5", 3.0", and 4.0

Surface Finish: Less than 0.6mm (RA) mechanical sanitary polish

Connections: Sanitary clamp, Buttweld and SMS

Pressure: Low pressure drops

Temperature / Vacuum: Vacuum to 1 bar at 68°F (20°C), temperature rating: 15°F to 200°F (10°C to 95°C)

Application: Water, Steam, Oil, Chemicals.

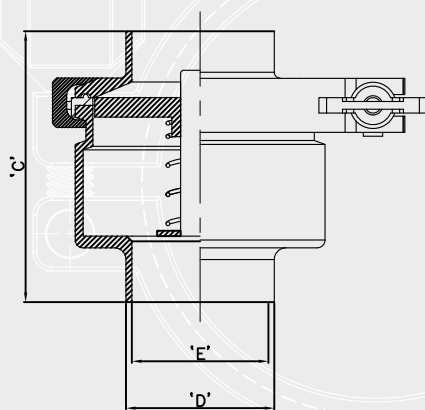

WELDED TYPE JOINT

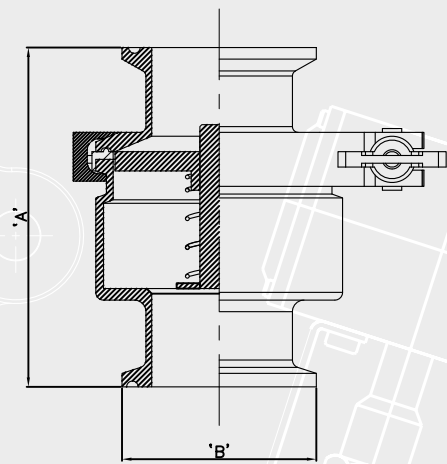

CLAMP TYPE JOINT

Dimensions

SIZE	A	B	C	D	E
1"	95	50.5	62.0	25.4	22.2
1-1/2"	95	50.5	68.6	38.1	34.8
2"	95.5	64.0	70.1	50.8	47.5

TC FERRULE



TC FERRULE

TC Clamp ferrules, blanks and adapters are produced by CNC turning from stainless steel bar, in AISI 34/316/316L materials.

STANDARDS

ASME BPE 2002, BS 4825 Part 3 / ISO 2037, DIN 32676 3A Standards, BS 6362 Schedule Pipe Size, ASTM A312 Schedule Pipe

SURFACE FINISH

The standard internal surface finish for clamp ferrules is 0.8-1.0 M Ra, With enhanced finishes of 0.38 M Ra or better available on request. Electro-polishing is also available to order.

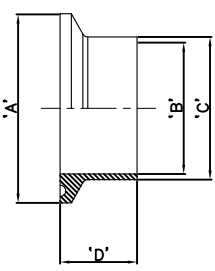

CLAMP FERRULE	Size	A	B	C	D	D	D	D
							Socket weld	Blanks Ferrule
	1/2"	25.3	9.5	12.70	20	15	7	5.6
	3/4"	25.3	15.8	19.05	20	15	7	6
	1"	50.5	22.2	25.65	20	15	7	7
	1.1/2"	50.5	34.9	38.35	20	15	7	7
	2"	64.0	47.6	51.05	20	15	7	7
	2.1/2"	77.5	60.3	63.75	20	15	8	7
	3"	91.0	73.0	76.45	20	15	8	7
	4"	119.0	97.6	101.85	20	15	10	9

TC CLAMPS

TC CLAMPS

The standard heavy - duty clamp are available from 1/2" to 12" in the single hinge pin design.

STANDARDS

ASME BPE-2002, BS 4825 Part 3 / ISO 2037, DIN 32676, 3A Standard, BS 6362 Schedule Pipe Size, ASTM A312 Schedule Pipe

SURFACE FINISH

Finishes and Materials and complies with standards including ASME BPE-2002, 3A, BS 4825 Part 3, DIN 32676 and ISO 2852.

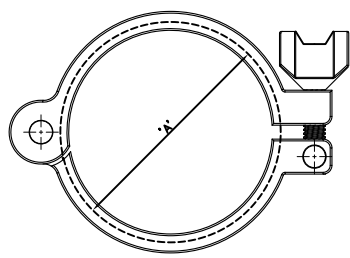

TC CLAMPS	Size	A	B	C	Max Working Pressure (Bar) at 20°C
	1/2" & 3/4"	28			30
	1" & 1 1/2"	54			20
	2"	67			20
	2 1/2"	81			20
	3"	94			20
	4"	122			10
	5"	148			10
	6"	170			10
	8"	220			5
	10"	272			-
	12"	322			-



TC Reducer



TC Tee



TC Nipple



Band



Diaphragm Valve



Serrated Hose Nozzle



TC Tank Ferrule



Side Glass



Tc Union



TC Bend



Filter Housing



Light Glass Tank

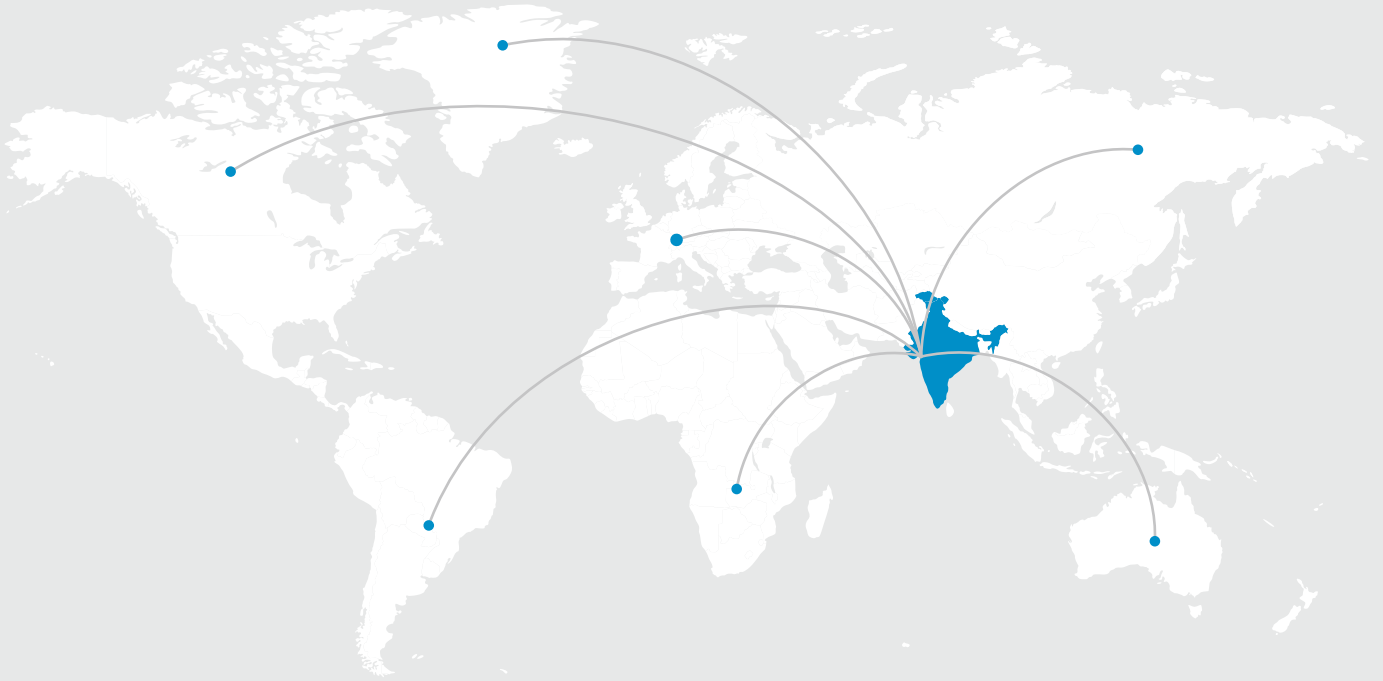

OUR BRANCHES

Regd. Office (Mumbai) :

Spraytech House, Plot No.: A-132, Road No. 23, Spraytech Circle,
Wagle Indl. Estate, Thane (W) - 400 604. Mumbai Maharashtra, (India)
Tel. : 91-022-2582 8929 / 2735 / 2736
E-mail :- sales@spraytechautomation.com | project@spraytechautomation.com

Branch Office (Pune) :

White House, Survey No. 161, Near
Bhosale Garden Hadapsar, Pune - 411 028.
E-mail :- sales@spraytechautomation.com

Rabale (Navi Mumbai) :

Spraytech Automation India Pvt. Ltd., Plot No.: R-446, T.T.C. Industrial
Area, MIDC Rabale, Navi Mumbai - 400 701.
Tel. : 91 99208 30555 / 99875 84555
E-mail :- sales@spraytechautomation.com | valves@spraytechautomation.com

Indapur Plant (Pune) :

Spraytech Automation India Pvt. Ltd., Plot No.: A1/1, Indapur Five Star
Industrial Area, Village - Loni Devkar Balpudi, Tal. - Indapur,
Dist. - Pune - 413 132.
Tel. : 91 99208 30555 / 99875 84555
E-mail :- sales@spraytechautomation.com | project@spraytechautomation.com



Visit Website